

3rd Floor

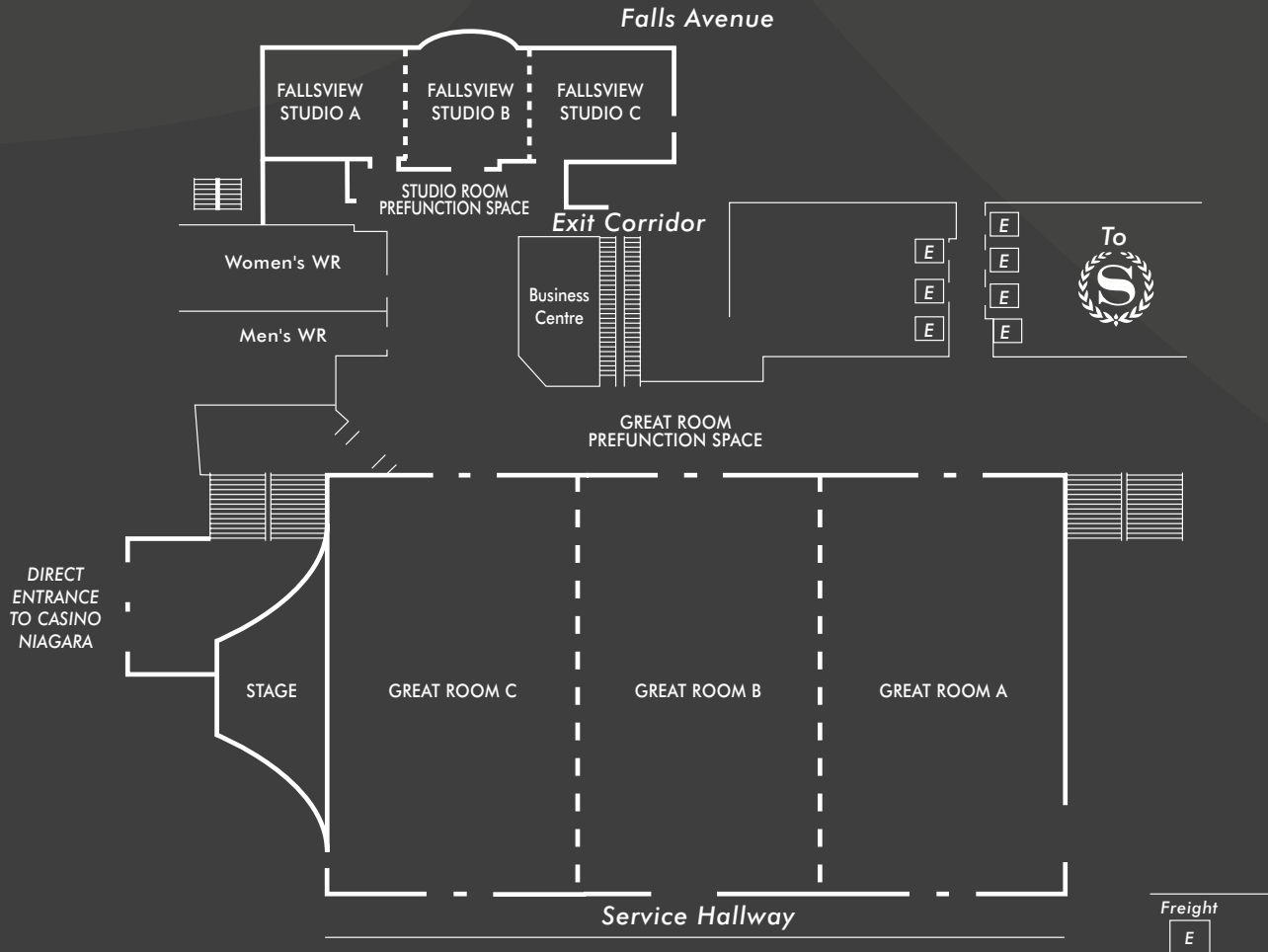

ROOM	DIMENSIONS (sq.ft.)	THETR	CLSRM	HLWSQ	CONFR	RECEP	BQT	BTH (8x10)	BTH (10x10)
Great Room ABC	165 x 86 = 14,190	2064	1000	-	-	1800	1440	102	84
Great Room A	55 x 86 = 4,730	600	350	70	80	550	480	38	32
Great Room B	55 x 86 = 4,730	600	350	70	80	550	480	38	32
Great Room C	55 x 86 = 4,730	600	350	70	80	550	480	38	32
Stage	23 x 33 = 759	-	-	-	-	-	-	-	-
Great Room Prefunction	28 x 180 = 5,042	-	-	-	-	500	-	-	-
Fallsview Studio ABC	95 x 27 = 2,565	160	120	-	-	200	168	-	-
Fallsview Studio A	34 x 26 = 884	60	36	22	20	80	60	-	-
Fallsview Studio B	27 x 27 = 729	40	24	18	16	60	36	-	-
Fallsview Studio C	34 x 26 = 884	60	36	22	20	80	60	-	-
Studio Room Prefunction	28 x 40 = 1,120	-	-	-	-	128	-	-	-

5th Floor

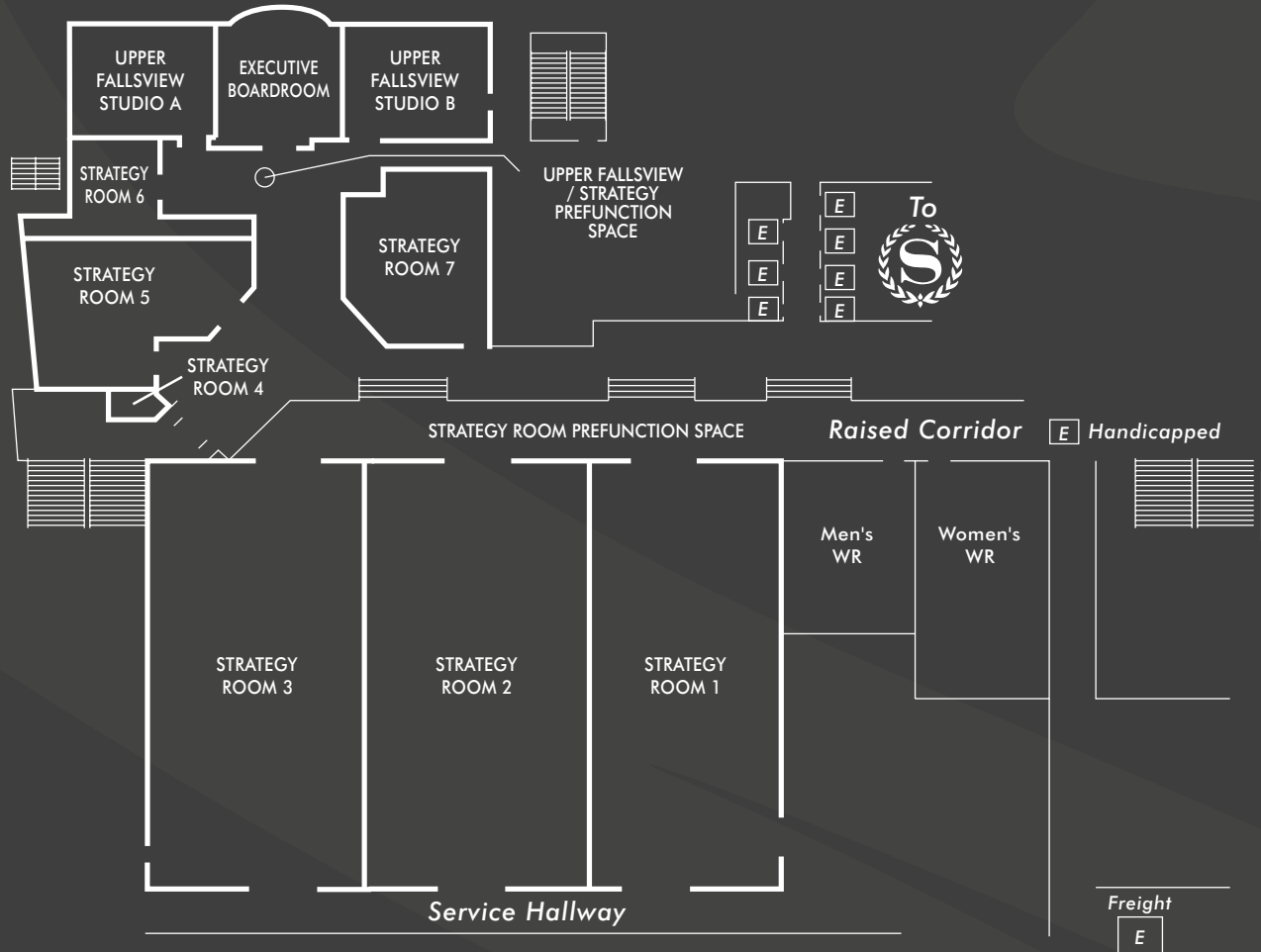

ROOM	DIMENSIONS (sq.ft.)	THETR	CLSRM	HLWSQ	CONFR	RECEP	BQT	
Strategy Room	30 x 51 = 1,530	140	90	40	35	160	108	
Strategy Room 2	38 x 51 = 1,938	170	120	50	45	190	144	
Strategy Room 3	38 x 51 = 1,938	170	120	50	45	190	144	
Strategy Room 5	38 x 26 = 988	55	36	30	24	85	48	
Strategy Room 6	21 x 19 = 399	20	12	12	8	30	12	
Strategy Room 7	30 x 37 = 1,110	75	50	24	22	85	72	
Upper Fallsview Studio A	33 x 25 = 825	55	36	18	16	60	48	
Upper Fallsview Studio B	35 x 25 = 875	60	36	22	16	70	60	
Prefunction Space	28 x 40 = 1,120	-	-	-	-	300	-	
Executive Boardroom	24 x 27 = 648	BOARDROOM ONLY (16 PEOPLE)						

Adjacent Meeting Space



1st Floor

5th Floor

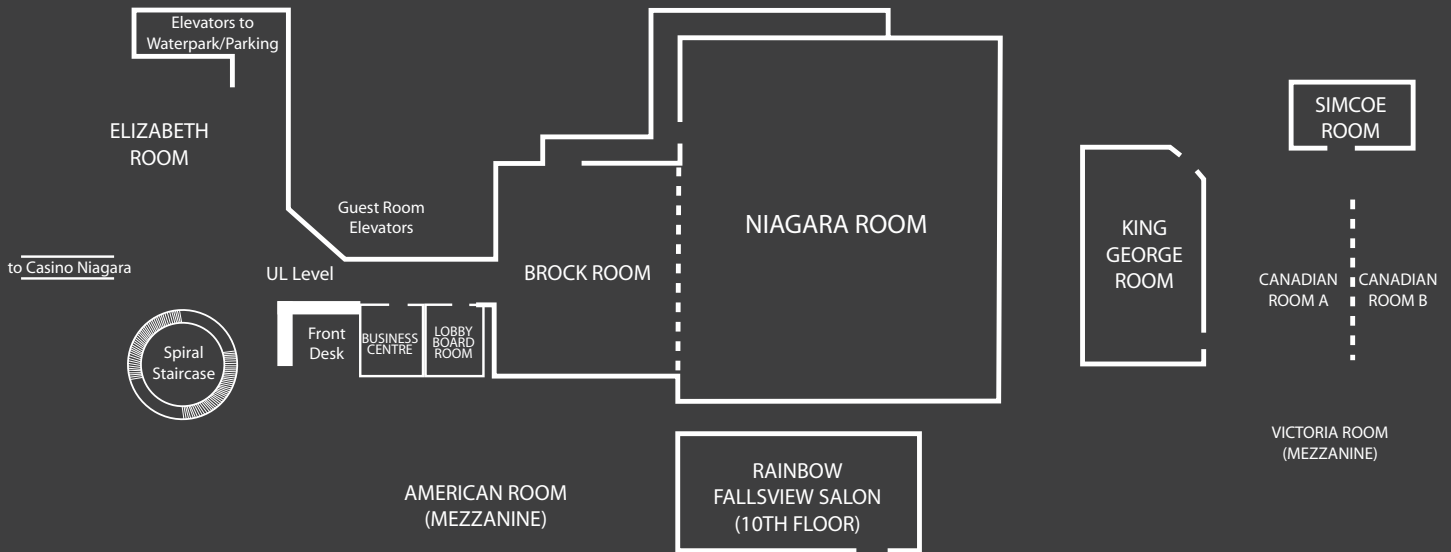

ROOM	DIMENSIONS (sq.ft.)	THETR	CLSRM	HLWSQ	RECEP	BQT	BTH (8x10)	BTH (10x10)
Grand Ballroom	7,578	850	504	-	830	696	72	60
Niagara Room	72 x 79 = 5,688	700	400	-	650	564	50	42
Brock Room	42 x 45 = 1,890	150	104	50	180	132	20	16
Rainbow Salon	44 x 42 = 1,848	120	77	40	160	132	-	-
Elizabeth Room	44 x 34 = 1,496	130	68	40	120	120	-	-
Canadian Room A/B	42 x 32 = 1,344	120	80	48	130	120	-	-
Canadian Room A	21 x 32 = 672	60	40	26	60	60	-	-
Canadian Room B	21 x 32 = 672	60	44	30	70	60	-	-
King George Room	22 x 42 = 924	70	48	38	90	72	-	-
American Room	31 x 23 = 713	60	36	32	70	60	-	-
Victoria Room	39 x 15 = 585	65	32	28	60	48	-	-
Lobby Boardroom	24 x 16 = 384	BOARDROOM ONLY (12 PEOPLE)						
Simcoe Room	23 x 11 = 253	BOARDROOM ONLY (12 PEOPLE)						